



5 Westlands Road, Herne Bay, Kent, CT6 7QP



Modern detached 3 bedroom bungalow located on the south side of town close to local shops and schools. 'Bus route at hand. Features gas central heating and double glazing. No forward chain.



**£249,995 Freehold**



## 'L'shaped Entrance Hall

Built-in cupboard. Consumer unit. Access to roof space. Power points.

## Front Bedroom

9'3 x 7'9 (2.82m x 2.36m)

Radiator. Power points.

## Front Bedroom

12'9 x 11'2 (3.89m x 3.40m)

Radiator. Power points.

## Side Bedroom

8'5 x 7'9 (2.57m x 2.36m)

Radiator. Power points.

## Bathroom

Panelled bath. Pedestal wash handbasin. Low level WC suite.

## Kitchen

16'2 x 8'5 (4.93m x 2.57m)

Base units. Wall cupboards. Gas hob. Electric oven. Recess and plumbed for washing machine. Integrated washing machine. Stainless steel sink unit. Double glazed door to garden. Cupboard housing gas boiler for central heating and hot water. Recess for fridge. Radiator. Power points.

## Lounge

15'7 x 10'6 (4.75m x 3.20m)

T.V. point. Power points. Side window. Radiator. Double glazed patio door to rear garden. Wall light.

## Rear garden

65' x 25' (19.81m x 7.62m)

With lawned areas. Base for shed. Side access and gate.

## Front garden

approx depth 17' x 25' width approx (approx depth 5.18m x 7.62m width approx)

Block paved for car standing room. Double gates - 9'9 wide approx plus pedestrian gate.

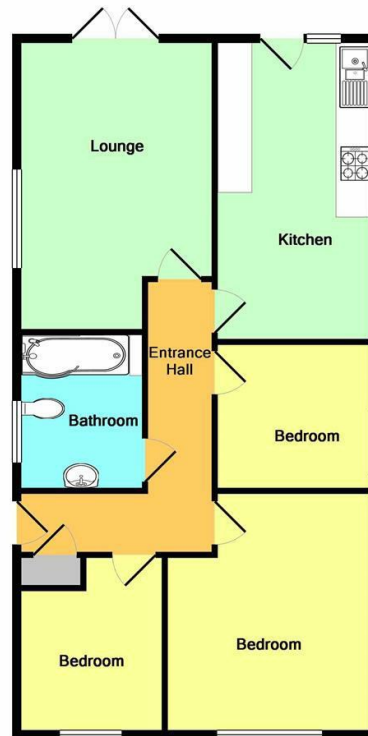

Whilst every attempt has been made to ensure the accuracy of the floor plan contained here, measurements of doors, windows, rooms and any other items are approximate and no responsibility is taken for any error, omission, or mis-statement. This plan is for illustrative purposes only and should be used as such by any prospective purchaser. The services, systems and appliances shown have not been tested and no guarantee as to their operability or efficiency can be given  
Made with Metropix ©2018

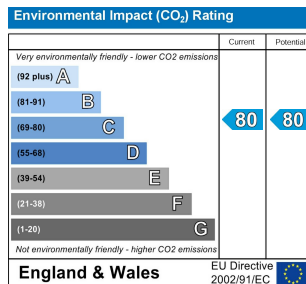
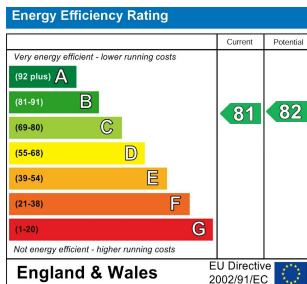

**Note:**

We have not tested the heating system, electrical appliances or the electric, gas and plumbing systems.

If travelling any distance to view this property it is advisable to check the availability and viewing times before hand. Wilbee & Son, as agents, cannot be held responsible for lost journey times and / or any expenses incurred.

These particulars are issued on the condition that any negotiations respecting the property are through Wilbee & Son. Every care is taken in giving particulars but should any error inadvertently occur or any property found to be previously withdrawn or disposed of, Wilbee & Son do not hold themselves responsible for any expenses or loss of time incurred. Neither the Vendor, nor the Partners or any employee of Wilbee & Son make or give any representation or warranty in relation to the property.

Oyster Financial Services is an appointed representative of Openwork Limited, which is authorised and regulated by the Financial Services Authority



